

EDUCATION CASE STUDY

KAPLAN LIVERPOOL INTERNATIONAL COLLEGE.

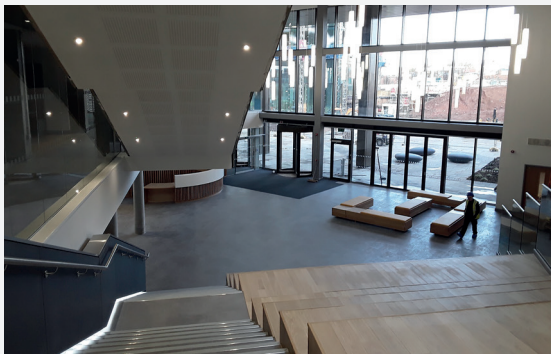

Project Summary

Kaplan are worldwide leaders in the provision of education and this project would provide them with a new educational facility together with accommodation for its students.

The brief required us to complete all internal decorations which were managed in 2 parts by the client split via academic and residential blocks.

The demands on this job were extensive with the programme being very behind meaning intense pressure on our team as a finishing trade.

Due to a slow start we provided minimal labour as areas were not freely available. This meant that as the project became readily available we had up to 16 painters onsite at any one time and often had to work evenings and weekends, as well as supplying additional labour at very short notice to ensure the programme did not fall further behind and therefore meet the clients demands.

Despite this pressure at an extremely busy time of the year, we worked successfully together with the client to produce a great looking and smoothly finished project.

Key Facts

Project Name	Kaplan Liverpool International College & Student Accommodation
Client	Kier
Service	Painting to new build educational facility
Length of Contract	12 months

Carlisle Office

Head Office, Brunthill Road, Kingstown Industrial Estate, Carlisle CA3 0EH T: 01228 404 114

Manchester Office

Unit 6, Westlink Business Park, Guide Street, Salford M50 1EW T: 0161 925 0412